

FIRST<sup>®</sup>  
EDITIONS

SHRUBS & TREES

# LANDSCAPE GUIDE FOR WARM CLIMATES

ZONES 6-9





**QUEEN BEE®  
CHASTETREE**

# WELCOME TO THE MOST FUN YOU'VE EVER HAD WITH SHRUBS AND TREES!

Let's face it. You've got a lot of options when it comes to plant selection for the landscape. And you've got time-tested favorites that have earned their place on your short list. So, we realize it can take a lot to try something different.

As you browse this brochure, you'll learn more about the intentionally selected varieties in the First Editions® Shrubs & Trees collection that are rewriting the book on how to talk about this foundational category.

Introduced for better flowering, greater disease resistance, mass planting appeal, native species benefits, low maintenance, and more, First Editions® provides you with plants you can trust. Plants that will perform year after year. Plants with purpose.

We invite you to take some time with this brochure, not just to look at our Rock Star plants, but also to learn the work that goes into each introduction, how they've been tested, landscape inspiration, and plants that provide solutions. Enjoy, and we look forward to working with you!

## Layci Gragnani

Brand & Business Development Manager  
layci.gragnani@baileynurseries.com

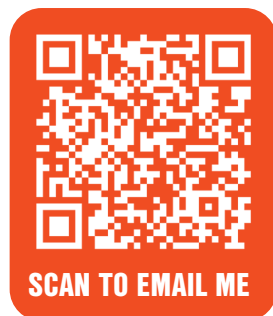

# THE FIRST EDITIONS® VIEWPOINT

First Editions® works to make shrubs and trees accessible to the trade and home gardeners. Easy solutions for tough problems. Sometimes that means providing a beautiful plant for a wet spot in the landscape. Sometimes that means a water-wise, adaptable plant as climate change affects our palette for the future. And sometimes it just means narrowing plant options to what works best in your region. We want to make finding the best plant for your site easy to find, easy to understand, and easy to use.

## COLLECTIONS APPROACH

To make that ease-of-use philosophy come to life, First Editions® is broken down into collections. So, if you're looking for plants for a specific region in North America, we've got you covered. If you're looking for plants for pollinators, we've broken that down for you. Have a client that wants a privacy hedge? There's a list for that! Keep flipping through these pages to find many of these tools, and head to the Resources tab on [BaileyNurseries.com](http://BaileyNurseries.com) for even more solutions to make using First Editions® easy as can be.



**LITTLE HOTTIE®  
PANICLE HYDRANGEA**

# THE BEST GENES

Removing the big challenges of shrubs and trees in the landscape starts with having the best plants on the market. We are incredibly proud of the First Editions® collection and stand behind their performance from propagation to the landscape. And we can do that because they go through such rigorous testing and trialing before introduction. If a plant is bred in-house at Bailey Innovations™, it can take seven to ten years from sowing seed to retail introduction.

Because we really want to ensure it performs as promised. Between Bailey Innovations™ breeding efforts and worldwide breeder partnerships, we are always looking for an improvement on an existing species, bringing a new species to the marketplace like we did with Distylium, and looking at the future needs of our landscapes as it relates to climate change.

We are methodical when introducing new varieties, only bringing something to market if it truly can stand on its own and be better than what already exists. We won't flood the system with plants simply for the sake of being new.



**David Roberts**  
Director of Plant Breeding at Bailey Innovations™

## LOOKING FOR LANDSCAPE SOLUTIONS?



We're here to make sure that you and your customers have success with First Editions®.

Subscribe today to our monthly Landscape Newsletter, and be in the know about our new introductions, tip and tricks, and much more.

# ★ ★ ★ ROCK STARS ★ ★ ★

While we are confident in every plant in First Editions®, we have some top selections that have gone above and beyond, demonstrating their reliability in production, at retail, and in the landscape. With more than 100 shrubs and trees to choose from, it can be difficult to make a selection on what to grow and sell. That's why we put together our handy list of Rock Stars to help make the decision for you.

Don't know where to begin? We've got you covered. These Rock Stars have earned their title through ultimate multi-region performance, versatility, outstanding visual interest — and will undoubtedly enhance any outdoor environment with strength, texture, and color. Flip to the next few pages for even more on some of our top Rock Stars in the landscape!

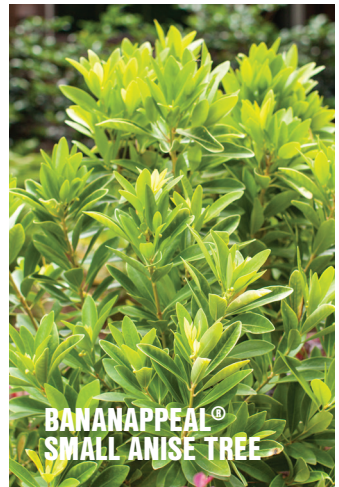

# BEST BUDS

Having individual Rock Stars is important, but knowing how to use them in the landscape with other plants is also a big deal. Our best-performing consumer advertising campaign is consistently what we call Best Buds. This is an easy how-to guide for pairing First Editions® plants with other perennials, shrubs, and trees.

We've shared some Best Buds ideas in this guide, but even more illustrations, lists, and ideas are available at [FIRSTEDITIONSPLANTS.COM](https://www.firsteditionsplants.com)



Find your Best Buds and follow along  
@FirstEditionsShrubsTrees



# BANANAPPEAL®

## SMALL ANISE TREE

*Illicium parviflorum* 'PIIP-I' PP28,887

### WHY IT ROCKS:

- Stunning golden-yellow foliage brightens up shady gardens
- A compact plant for shade in residential or commercial properties
- An improved native variety with disease resistant foliage

### HOW TO USE IT:

- A bright specimen in the landscape or decorative pots
- Group plantings on its own or mixed with other shrubs

### BEST BUDS:

- Jetstream™ Oakleaf Hydrangea
- Eclipse® Bigleaf Hydrangea
- Love Child® Sweetspire

HEIGHT	WIDTH	SHAPE
3-4'	3-4'	Upright, Round
ZONE	EXPOSURE	
7-9	Part Sun to Full Shade	



# FLIP SIDE<sup>®</sup> CHASTETREE

*Vitex* x 'Bailtexone' PP30,283

## WHY IT ROCKS:

- A strong rebloomer and pollinator magnet
- Remains compact for smaller landscapes
- Unique greyish leaves that are dusky purple on the lower surface
- Outstanding cold hardiness to Zone 7

## HOW TO USE IT:

- Plant where the purple bottom of the leaf can be visible while flickering in the wind
- Specimen planting with smaller shrubs

## BEST BUDS:

- Lunar Magic<sup>®</sup> Crapemyrtle
- Vintage Jade Distylium
- Sweet Tea<sup>™</sup> Gardenia



HEIGHT	WIDTH	SHAPE
6-8'	8-10'	Upright, Arching
ZONE	EXPOSURE	
7-9	Full Sun	

# LUNAR MAGIC<sup>®</sup> CRAPEMYRTLE

*Lagerstroemia* 'Baillagone' PP30,360

## WHY IT ROCKS:

- Rich, purple-black foliage with white flowers on red stems
- Flowers begin in June and will rebloom through fall if deadheaded
- Disease-resistant, upright oval shape makes a great focal point or hedge

## HOW TO USE IT:

- Commercial properties along parking lots and in road medians
- Underplant with smaller shrubs or use as a specimen

## BEST BUDS:

- Coppertone<sup>™</sup> Distylium
- Little Hottie<sup>®</sup> Panicle Hydrangea
- Cool Glow<sup>®</sup> Pomegranate Nandina



HEIGHT	WIDTH	SHAPE
7-9'	5-7'	Upright, oval
ZONE	EXPOSURE	
7-9	Full Sun	

# VINTAGE JADE DISTYLIUM

*Distylium* 'Vintage Jade' PP23,128

## WHY IT ROCKS:

- Lustrous, dark green, disease resistant foliage is attractive all season
- Layered branches form a spreading mound in the landscape
- Evergreen shrub that is ideal for foundation or mass plantings

## HOW TO USE IT:

- Plant in groups along a foundation, walkway, or on a slope for erosion control
- As a replacement for boxwood

## BEST BUDS:

- Flip Side® Chastetree
- Sunset Magic™ Crapemyrtle
- Spring Sizzle® Panicle Hydrangea



HEIGHT	WIDTH	SHAPE
3-4'	3-4'	Spreading
ZONE	EXPOSURE	
7-9	Full Sun to Part Shade	

# CENTENNIAL BLUSH STAR MAGNOLIA

*Magnolia stellata* 'Centennial Blush' PP22,248

## WHY IT ROCKS:

- Produces star shaped flowers at almost every node
- Features an attractive upright, oval habit
- Medium green foliage turns yellow or bronze in autumn

## HOW TO USE IT:

- A burst of fragrant, large, pink blooms that provide beautiful contrast to evergreens
- Specimen in front of an office or house that provides spring color and summer shade

## BEST BUDS:

- Vanilla Brandy™ Abelia
- Cinnamon Girl® Distylium
- Psychedelic Sky™ Butterfly Bush



HEIGHT	WIDTH	SHAPE
12-18'	10-15'	Upright Oval
ZONE	EXPOSURE	
4-9	Full Sun	

# SPRING SIZZLE® PANICLE HYDRANGEA

*Hydrangea paniculata* 'Bailpanthree' PP36,526

## WHY IT ROCKS:

- One of the earliest blooming panicle hydrangeas with unforgettable blooms and color
- The white flowers quickly transform to deep red, even in warm regions
- A medium sized panicle that is perfect for hedges and foundations

HEIGHT	WIDTH	SHAPE
4-6'	4-5'	Upright, Vase
ZONE	EXPOSURE	
3-8	Full Sun to Part Shade	

## HOW TO USE IT:

- Perfect for hedges and foundation plantings
- A colorful focal point surrounded by smaller shrubs

## BEST BUDS:

- Little Hottie® Panicle Hydrangea
- Crimson Fire™ Fringe Flower
- Love Child® Sweetspire



Both pictures were taken in Athens, Georgia (Zone 8) on June 20th, 2025.

# PROBLEM SOLVERS

Adding shrubs to your landscape is an excellent way to provide structure, frame buildings, anchor designs, and create year-round interest. Check this handy chart when designing to take advantage of all these Rock Stars have to offer.

FIRST EDITIONS® ROCK STARS	SIZE		SUN NEEDS	ZONE	
	H	W			
<b>BananAppeal®</b> Small Anise Tree	3-4'	3-4'		7-9	
<b>Flip Side®</b> Chastetree	6-8'	8-10'		7-9	
<b>Lunar Magic®</b> Crapemyrtle	7-9'	5-7'		7-9	
<b>Purple Magic</b> Crapemyrtle	7-10'	7-10'		7-9	
<b>Cinnamon Girl®</b> Distylium	2-3'	3-4'		7-9	
<b>Vintage Jade</b> Distylium	3-4'	4-5'		7-9	
<b>Crimson Fire™</b> Fringe Flower	4'	4-5'		7-9	
<b>Bali™</b> Hibiscus	5-8'	4-7'		5-8	
<b>Straight &amp; Narrow®</b> Japanese Holly	6-8'	2-3'		6-8	
<b>Eclipse®</b> Bigleaf Hydrangea	3-5'	3-5'		5-9	
<b>Berry White®</b> Panicle Hydrangea	6-7'	4-5'		3-8	
<b>Little Hottie®</b> Panicle Hydrangea	3-5'	3-5'		3-8	
<b>Spring Sizzle®</b> Panicle Hydrangea <b>NEW FOR 2026!</b>	4-6'	4-5'		3-8	
<b>White Diamonds®</b> Panicle Hydrangea	4-6'	5'		3-8	
<b>Cobalt-n-Gold™</b> Hypericum	2-3'	4-5'		4-7	
<b>Centennial Blush</b> Star Magnolia	12-18'	10-15'		4-9	

**LOOKING FOR THE FULL LIST?  
SCAN THE QR CODE!**



	DROUGHT TOLERANT	WET SOILS	SALT TOLERANT	DEER RESISTANT*	GOOD FOR CONTAINERS	NORTH AMERICAN NATIVE SPECIES	ATTRACTS POLLINATORS	MASS PLANTING	SCREENING & HEDGES	ADDED INTEREST
				●	●	●		●		Fragrant blooms
	●		●	●			●			Fragrant blooms
	●			●			●		●	
	●			●			●		●	Beautiful fall color
	●	●		●				●		
	●	●		●				●		
	●			●				●		Beautiful fall color
			●	●			●		●	
			●						●	
			●		●			●		
	●								●	Striking fall bloom color
	●				●			●		
	●				●			●		
	●						●		●	
	●		●	●	●	●	●	●		
				●			●		●	Fragrant blooms

\*Deer resistance can be regional and circumstantial. These designations are based on the Rutgers New Jersey Agricultural Experiment Station research, as available.

# SEASONAL COLOR

In addition to tactical solutions, the aesthetic is also important. Review this color chart for how the plants will appear in the landscape so that you can pair accordingly for seasonal interest.

	SPRING	
<b>BananAppeal</b> ® Small Anise Tree	Golden-Yellow Foliage	
<b>Flip Side</b> ® Chastetree	Olive-Green Foliage	
<b>Lunar Magic</b> ® Crapemyrtle	Purple-Black Foliage	
<b>Purple Magic</b> Crapemyrtle	Green Foliage	
<b>Cinnamon Girl</b> ® Distylium	Plum-Purple New Growth	
<b>Vintage Jade</b> Distylium	Dark Green Evergreen Foliage	
<b>Crimson Fire</b> ™ Fringe Flower	Red Foliage with Pink Blooms	
<b>Bali</b> ™ Hibiscus	Green Foliage	
<b>Straight &amp; Narrow</b> ® Japanese Holly	Dark Green Foliage	
<b>Eclipse</b> ® Bigleaf Hydrangea	Dark Purple Foliage	
<b>Berry White</b> ® Panicle Hydrangea	Green Foliage	
<b>Little Hottie</b> ® Panicle Hydrangea	Green Foliage	
<b>Spring Sizzle</b> ® Panicle Hydrangea <b>NEW FOR 2026!</b>	Green Foliage, White Blooms	
<b>White Diamonds</b> ® Panicle Hydrangea	Green Foliage	
<b>Cobalt-n-Gold</b> ™ Hypericum	Blue/Silver/Green Foliage	
<b>Centennial Blush</b> Star Magnolia	Pink Buds Open to Almost Pure White Blooms	

**LOOKING FOR THE FULL LIST?  
SCAN THE QR CODE!**



	<b>SUMMER</b>	<b>FALL</b>	<b>WINTER</b>
	Golden-Yellow Foliage		
	Deep Purple Blooms		
	White Blooms with Purple-Red Center	Purple-Black Foliage	
	Dark Purple Blooms	Green Foliage	
	Dark Green Evergreen Foliage		
	Dark Green Evergreen Foliage		
	Red Evergreen Foliage		
	White Blooms with Purple-Red Center		
	Dark Green Foliage		
	Dark Purple Foliage with Cranberry Blooms		
	White Blooms	White Blooms Fade to Dark Pink	
	White Blooms	White Blooms Fade to Light Pink	
	White Blooms Quickly Turn Deep Red	Red Blooms Fade to Antique	
	White Blooms	White Blooms Fade to Parchment and Pink	
	Yellow Blooms	Shades of Yellow, Orange, and Red Foliage	Exfoliating Bark
	Green Foliage	Yellow-Bronze Foliage	

# BEST BUDS

## ROCK STAR FEATURE PRODUCTS



### ECLIPSE® BIGLEAF HYDRANGEA

Eclipse® is a groundbreaking hydrangea that features deep purple foliage that remains dark all summer long. And that's not all! The striking foliage contrasts beautifully with the cranberry colored blooms. At three to five feet, Eclipse® is right at home in any landscape or outdoor space, and the colors are perfect for pairing with anything in the garden.

Height: 3-5' | Width: 3-5' | Zone: 5-9  
 Shape: Mounded | Exposure: Morning Sun, Afternoon Shade

### MORE ECLIPSE® BEST BUDS:

- Cinnamon Girl® Distylium
- Little Hottie® Panicle Hydrangea
- Crimson Fire™ Fringe Flower
- Love Child® Sweetspire
- Double Mint Gardenia



The features of Eclipse® (1) can be showcased in an entry walkway, along with Vanilla Brandy™ Abelia (2), Northern Exposure™ Black Coral Bells (3), and Karl Foerster Feather Reed Grass (4).

**SPRING SIZZLE® TURNS COLORS MUCH EARLIER IN THE SEASON THAN OTHER PANICULATAS IN THE MARKET. USE IT AS A COLORFUL FOCAL POINT IN RESIDENTIAL AND COMMERCIAL LANDSCAPES!**



### **SPRING SIZZLE® PANICLE HYDRANGEA**

Spring Sizzle® Panicle Hydrangea is one of the earliest blooming panicle hydrangeas that brings unforgettable blooms and color to the garden. Flowers are held up on strong stems and bloom white before transforming to deep red, even in warm regions.

Height: 4-6' | Width: 4-5' | Zone: 3-8

Shape: Upright, Vase

Exposure: Full Sun to Part Shade

### **MORE SPRING SIZZLE® BEST BUDS:**

- Cobalt-n-Gold™ Hypericum
- Lucky Devil® Ninebark
- Crimson Fire™ Fringe Flower
- Tianshan® Seven-son Flower



Combine Spring Sizzle® (1) with the darker leaves of Cinnamon Girl® Distylium (2) to frame it and create a focal point. Use Little Spark® Spirea (3) and geranium to anchor and emphasize Spring Sizzle®'s red blooms. Finally use grass to finish framing the vignette.

# BEST BUDS | ROCK STAR FEATURE PRODUCTS



## LITTLE HOTTIE® PANICLE HYDRANGEA

This compact hydrangea makes a big statement in the landscape, with massive white blooms that cover the plant from top to bottom. Little Hottie® was bred for the heat and can be used in almost any landscape. It remains three to five feet tall and wide, making it the perfect companion for annuals, perennials and other shrubs. This hydrangea can be grown as a specimen or planted in groups to maximize the bloom power. Little Hottie® has a natural branching habit that minimizes the need for pruning, while creating a full plant.

Height: 3-5' | Width: 3-5' | Zone: 3-8  
Shape: Rounded | Exposure: Full Sun to Part Shade



In residential sites, Little Hottie® (1) shines in foundation beds and borders. Plant it with dark-leaf shrubs like Sunset Magic™ Crapemyrtle (2) to highlight the vibrant white blooms. In a cottage garden, Little Hottie® is the right size for mixing with other plants like Easy Elegance® Kashmir Rose (3), Endless Summer® Pop Star® Reblooming Hydrangea (4), or Rozanne Geranium.



#### **MORE LITTLE HOTTIE® BEST BUDS:**

- Purple Magic Crapemyrtle
- Vintage Jade Distylium
- Flip Side® Chastetree
- Chubby Hubby™ Japanese Holly
- Opening Day™ Viburnum



Little Hottie® (1) has many landscape applications, including commercial properties. Its compact stature and heat tolerance is excellent for use along sidewalks and parking lots. Little Hottie® is an excellent companion plant for Superstar™ Spirea (2) and Flip Side® Chastetree (3), which also do well in this commercial setting.

# BEST BUDS | ROCK STAR FEATURE PRODUCTS



## CRIMSON FIRE™ FRINGE FLOWER

Crimson Fire™ is a truly compact red-leaf fringe flower with beautiful evergreen foliage. This well-behaved selection has controlled growth that reduces the need for pruning, keeping it low-maintenance. In spring, the bright pink flowers look stunning alongside the rich dark foliage.

Height: 4' | Width: 4-5' | Zone: 7-9  
Shape: Mounded | Exposure: Full Sun to Part Shade



In residential landscapes, use Crimson Fire™ (1) to provide structure near outdoor living spaces, walkways, and foundation beds. It makes a beautiful backdrop for annual beds and can be mixed with small-to-midsize shrubs like Little Hottie® Panicle Hydrangea (2), Vanilla Brandy™ Abelia (3), or fragrant Sweet Tea™ Gardenia (4).

### MORE CRIMSON FIRE™ FRINGE FLOWER BEST BUDS:

- Tianshan® Seven-Son Flower
- Jetstream™ Hydrangea
- Ruffled Red Magic™ Crapemyrtle
- Flip Side® Chastetree
- Centennial Blush Star Magnolia

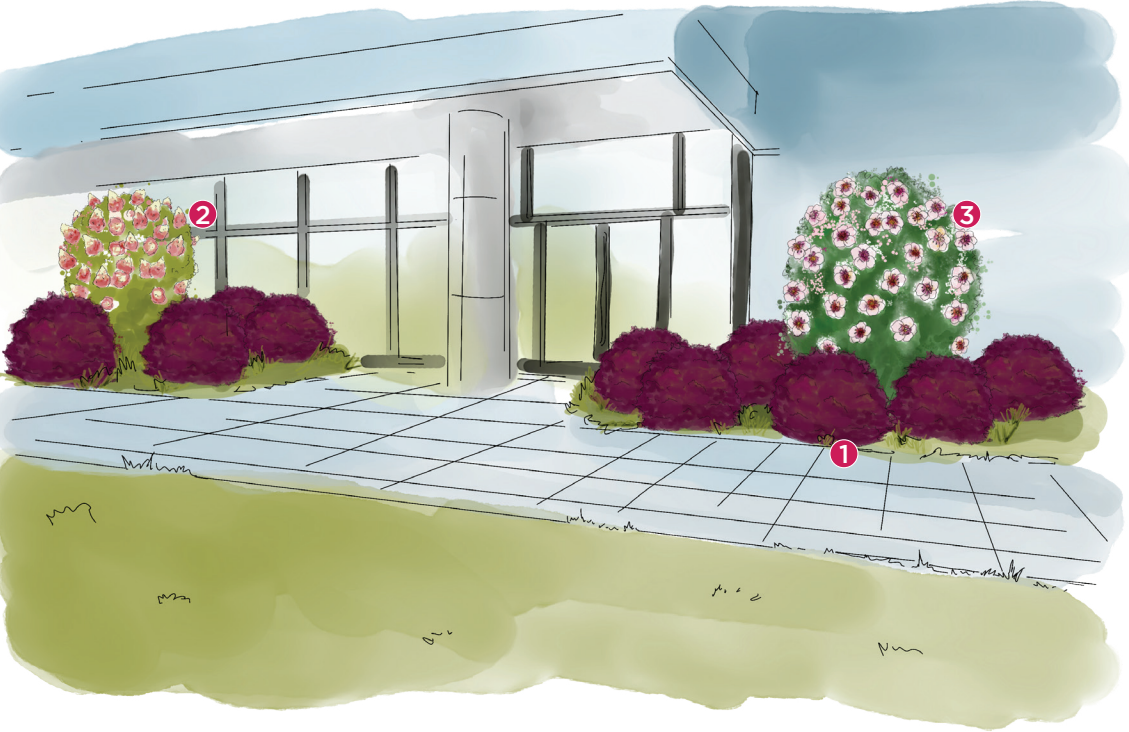

The compact size of Crimson Fire™ (1) gives it fantastic versatility. In commercial landscapes, it can be mass planted in parking lots, along sidewalks, and used as a backdrop for seasonal beds. For more interest, add height to the planting with Berry White® Hydrangea (2), Bali™ Hibiscus (3), or Lunar Magic® Crapemyrtle. Crimson Fire™ is an evergreen shrub, providing year-round interest.

# RESOURCES + MARKETING SOLUTIONS



Loving what you're seeing and want some more info? We've got you covered! Our goal is to make First Editions® easy to grow, spec, sell, and install, so we've built the tools you need to be successful.

Visit [BaileyNurseries.com/Resources](https://BaileyNurseries.com/Resources) or scan the QR code for a full photo library, design ideas, each varieties' cultural information, fact sheets, signage options, and more. All this information is free and accessible for all! And if you need something custom for your needs, let us know and we're happy to work with you.

## FIND AND USE OUR PLANTS IN YOUR DESIGNS AND LANDSCAPE PLANS!



# GROWER NETWORK

Looking for First Editions® plants in your area? These trusted partners offer great regional selections. For the full list, scan the QR code. Contact any of these licensed growers for availabilities.

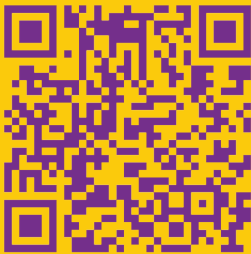
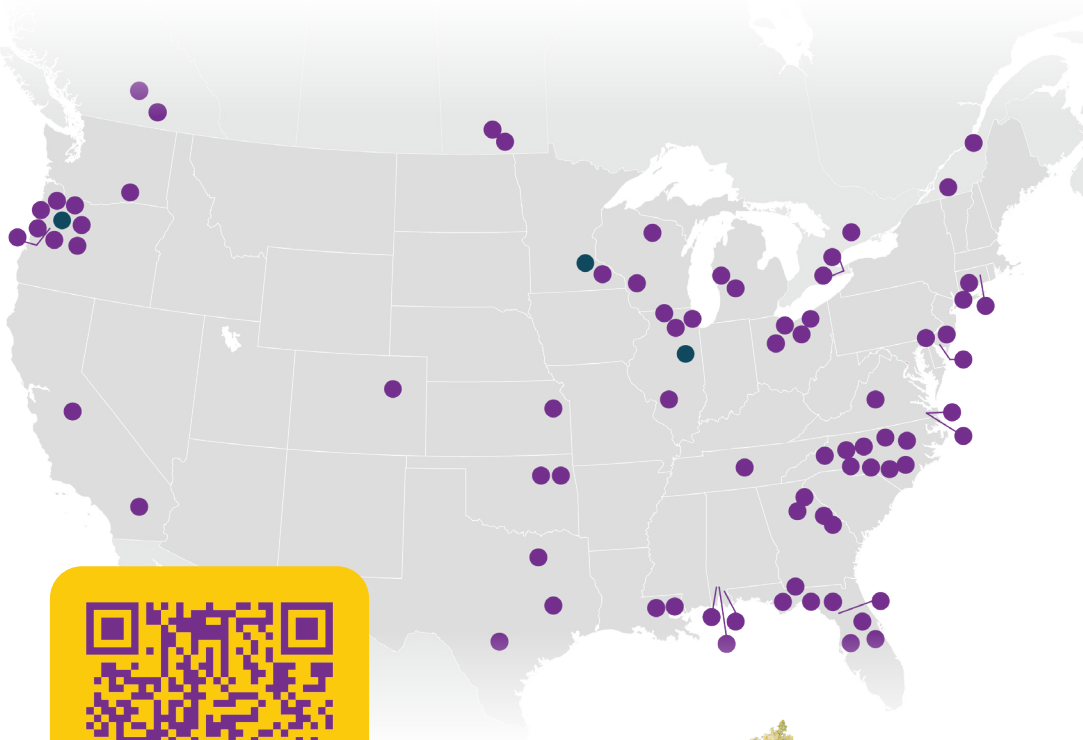

SCAN ME

If you have any questions or need more information about First Editions®, please contact [landscape@firsteditionsplants.com](mailto:landscape@firsteditionsplants.com)



CRIMSON FIRE™  
FRINGE FLOWER

LITTLE HOTTIE®  
PANICLE HYDRANGEA

VINTAGE JADE  
DISTYLIUM

@firsteditionsshrubstrees



firsteditionsplants.com